

Tract 6381
126 single-family units

SE corner of 25th West & Orange (South of Rosamond Blvd and just west of the 14 Fwy)

Comment period closes Feb 8, 2005

Hearing scheduled Feb 24, 2005

This project is approximately 2 miles from the Skypark.

NOTICE OF PUBLIC HEARING

The **Kern County Planning Commission** will hold a hearing on **Thursday, February 24, 2005, at 7:00 p.m.** (or as soon as possible thereafter as the matter may be heard) to consider the request listed below. Anyone wishing to give pertinent testimony may appear and be heard. Location of the hearing is:

Chambers of the Board of Supervisors
First Floor - Kern County Administrative Center
1115 Truxtun Avenue (corner of Truxtun and "N"), Bakersfield, California

Free parking is available in the parking structure located south of the Administrative Center. If parking fees are being charged for an event, inform the parking attendant you are attending the Planning Commission hearing, and you will not be charged.

Applicant: Epic Mortgage Corporation by Cornerstone Engineering, Inc.

Location: Southeast corner of 25th Street West and Orange Street alignments, Rosamond

Proposal: Tentative Tract 6381 proposing to divide an approximate 32-acre parcel into 126 single-family residential lots ranging in size from 6,500 square feet to 13,359 square feet and one sump lot; four limited design variations. This project qualifies as a special situation and does not require preparation of further environmental documents pursuant to Section 15182 of the State CEQA Guidelines.

If you have comments about this proposal you are encouraged to send them in writing. To ensure that your comments related to this request are incorporated into the Staff Report that is presented at the hearing, please try to submit all correspondence by February 8, 2005. Correspondence should be sent to:

Kern County Planning Department
2700 "M" Street, Suite 100
Bakersfield, CA 93301

Please make reference to the file number: **TR #6381**

If you have questions regarding this project, telephone the Kern County Planning Department and speak to:

Suzanne Z. Forrest, Supervising Planner ((661) 862-8625)

If you challenge the action taken on this request in court, you may be limited to raising only those issues you or someone else raised at this public hearing, or in written correspondence delivered to the Planning Department at, or prior to, the public hearing.

Tentative Tract No. 6381

ZONING MAP 230-20 (SEC. 7297175.34 of the ORDINANCE CODE OF KERN COUNTY) SEC. 20 T9N. R12W. S.B.B. & M.

KERN COUNTY CALIFORNIA
DEPARTMENT OF PLANNING AND DEVELOPMENT SERVICES

LEGEND

- E(1/1) (ESTATE - 1 ACRE)
- E(2/1/2) (ESTATE-2 1/2 ACRES)
- E(1/2) (ESTATE-1/2 ACRE)
- R-1 (LOW-DENSITY RESIDENTIAL)
- R-2 (MEDIUM-DENSITY RESIDENTIAL)
- R-3 (HIGH-DENSITY RESIDENTIAL)
- MS (MOBILEHOME SUBDIVISION-6000 SQ FT)
- MS(1/4) (MOBILEHOME SUBDIVISION-1/4 ACRE)
- MP (MOBILEHOME PARK)
- CO (COMMERCIAL OFFICE)
- C-1 (NEIGHBORHOOD COMMERCIAL)
- C-2 (GENERAL COMMERCIAL)
- CH (HIGHWAY COMMERCIAL)
- M-1 (LIGHT INDUSTRIAL)
- M-2 (MEDIUM INDUSTRIAL)
- M-3 (HEAVY INDUSTRIAL)
- D (DRILLING ISLAND)
- A-1 (LIMITED AGRICULTURE)
- PD (PRECISE DEVELOPMENT COMBINING)
- RS (RESIDENTIAL SUBURBAN COMBINING)
- MH (MOBILEHOME COMBINING)
- FPS (FLOODPLAIN-SECONDARY COMBINING)
- D (ARCHITECTURAL DESIGN COMBINING)
- H (AIRPORT APPROACH HEIGHT COMBINING)
- CL (CLUSTER COMBINING)

WE HEREBY CERTIFY THAT THIS OFFICIAL "ZONING MAP" WAS ADOPTED IN THIS FORM BY RESOLUTION OF THE PLANNING COMMISSION OF THE COUNTY OF KERN, STATE OF CALIFORNIA, AT A REGULAR MEETING THEREOF HELD ON THE 20TH DAY OF JULY 1984, AND AS REVISED BY THE BOARD OF SUPERVISORS AFTER PUBLIC HEARING WHICH REVISION WAS REPORTED ON AND APPROVED BY THE PLANNING COMMISSION ON THE 8TH DAY OF SEPTEMBER 1984, IN THE MANNER PRESCRIBED BY LAW.

John P. Keston
PLANNING CHAIRMAN
SECRETARY

WE HEREBY CERTIFY THAT THIS OFFICIAL ZONING MAP WAS ADOPTED AS AN AMENDMENT TO THE OFFICIAL LAND USE ZONING ORDINANCE OF THE COUNTY OF KERN BY THE BOARD OF SUPERVISORS OF THE COUNTY OF KERN, STATE OF CALIFORNIA, AT A REGULAR MEETING THEREOF HELD ON THE 22ND DAY OF SEPT 1984, BY AN URGENCY ORDINANCE PASSED BY SAID BOARD TO BE EFFECTIVE IMMEDIATELY.

Charles J. Gibson
CLERK
CLERK OF THE BOARD

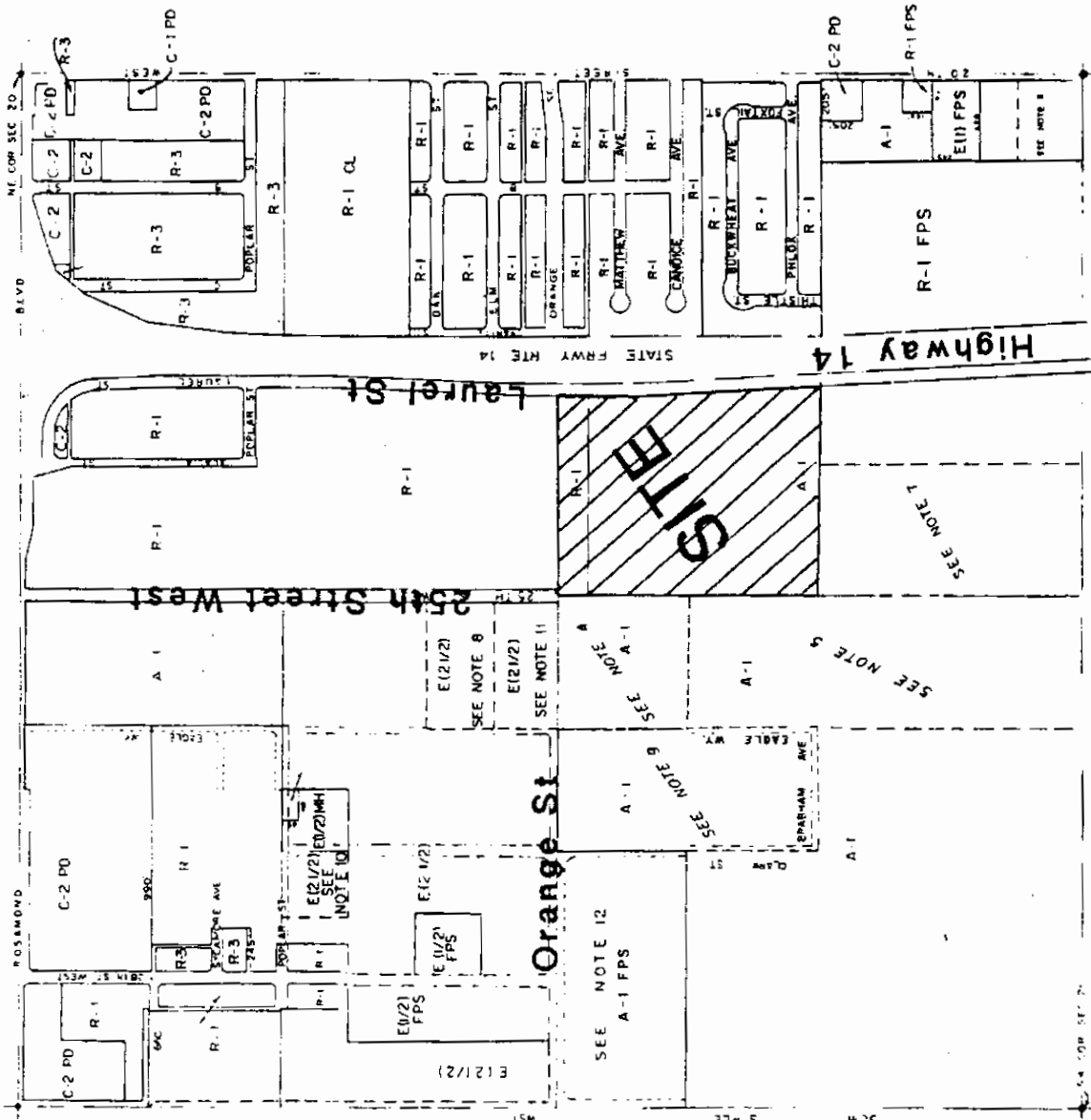
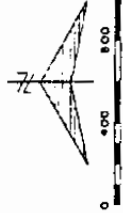

- NOTE
- 1 ORD G-4335
 - 2 ORD G-4352
 - 3 ORD G-4658
 - 4 ORD G-4658
 - 5 ORD G-4828
 - 6 ORD G-5020
 - 7 ORD G-5052
 - 8 ORD G-5057
 - 9 ORD G-5111
 - 10 ORD G-5111
 - 11 SEE ORD G-5122
 - 12 (SEE) A-1 FPS TO R-1 FPS, IN SUP

- AMENDMENTS
- 101 ORD NO G-4837 DATED FEB 15, 1986
 - 102 ORD NO G-4838 DATED FEB 15, 1986
 - 103 ORD NO G-4839 DATED FEB 15, 1986
 - 104 ORD NO G-4840 DATED FEB 15, 1986
 - 105 ORD NO G-4841 DATED FEB 15, 1986
 - 106 ORD NO G-4842 DATED FEB 15, 1986
 - 107 ORD NO G-4843 DATED FEB 15, 1986
 - 108 ORD NO G-4844 DATED FEB 15, 1986
 - 109 ORD NO G-4845 DATED FEB 15, 1986
 - 110 ORD NO G-4846 DATED FEB 15, 1986
 - 111 ORD NO G-4847 DATED FEB 15, 1986
 - 112 ORD NO G-4848 DATED FEB 15, 1986
 - 113 ORD NO G-4849 DATED FEB 15, 1986
 - 114 ORD NO G-4850 DATED FEB 15, 1986
 - 115 ORD NO G-4851 DATED FEB 15, 1986
 - 116 ORD NO G-4852 DATED FEB 15, 1986
 - 117 ORD NO G-4853 DATED FEB 15, 1986
 - 118 ORD NO G-4854 DATED FEB 15, 1986
 - 119 ORD NO G-4855 DATED FEB 15, 1986
 - 120 ORD NO G-4856 DATED FEB 15, 1986
 - 121 ORD NO G-4857 DATED FEB 15, 1986
 - 122 ORD NO G-4858 DATED FEB 15, 1986
 - 123 ORD NO G-4859 DATED FEB 15, 1986
 - 124 ORD NO G-4860 DATED FEB 15, 1986
 - 125 ORD NO G-4861 DATED FEB 15, 1986
 - 126 ORD NO G-4862 DATED FEB 15, 1986
 - 127 ORD NO G-4863 DATED FEB 15, 1986
 - 128 ORD NO G-4864 DATED FEB 15, 1986
 - 129 ORD NO G-4865 DATED FEB 15, 1986
 - 130 ORD NO G-4866 DATED FEB 15, 1986
 - 131 ORD NO G-4867 DATED FEB 15, 1986
 - 132 ORD NO G-4868 DATED FEB 15, 1986
 - 133 ORD NO G-4869 DATED FEB 15, 1986
 - 134 ORD NO G-4870 DATED FEB 15, 1986
 - 135 ORD NO G-4871 DATED FEB 15, 1986
 - 136 ORD NO G-4872 DATED FEB 15, 1986
 - 137 ORD NO G-4873 DATED FEB 15, 1986
 - 138 ORD NO G-4874 DATED FEB 15, 1986
 - 139 ORD NO G-4875 DATED FEB 15, 1986
 - 140 ORD NO G-4876 DATED FEB 15, 1986
 - 141 ORD NO G-4877 DATED FEB 15, 1986
 - 142 ORD NO G-4878 DATED FEB 15, 1986
 - 143 ORD NO G-4879 DATED FEB 15, 1986
 - 144 ORD NO G-4880 DATED FEB 15, 1986
 - 145 ORD NO G-4881 DATED FEB 15, 1986
 - 146 ORD NO G-4882 DATED FEB 15, 1986
 - 147 ORD NO G-4883 DATED FEB 15, 1986
 - 148 ORD NO G-4884 DATED FEB 15, 1986
 - 149 ORD NO G-4885 DATED FEB 15, 1986
 - 150 ORD NO G-4886 DATED FEB 15, 1986
 - 151 ORD NO G-4887 DATED FEB 15, 1986
 - 152 ORD NO G-4888 DATED FEB 15, 1986
 - 153 ORD NO G-4889 DATED FEB 15, 1986
 - 154 ORD NO G-4890 DATED FEB 15, 1986
 - 155 ORD NO G-4891 DATED FEB 15, 1986
 - 156 ORD NO G-4892 DATED FEB 15, 1986
 - 157 ORD NO G-4893 DATED FEB 15, 1986
 - 158 ORD NO G-4894 DATED FEB 15, 1986
 - 159 ORD NO G-4895 DATED FEB 15, 1986
 - 160 ORD NO G-4896 DATED FEB 15, 1986
 - 161 ORD NO G-4897 DATED FEB 15, 1986
 - 162 ORD NO G-4898 DATED FEB 15, 1986
 - 163 ORD NO G-4899 DATED FEB 15, 1986
 - 164 ORD NO G-4900 DATED FEB 15, 1986

